



Funded by the  
Erasmus+ Programme  
of the European Union



# Demolition/renovation site management

Lecturer Sami Niku-Paavo





Funded by the  
Erasmus+ Programme  
of the European Union



# Building site management

## Safety

- Workers
- Visitors
- Client/ people
- Neighborhood

## Logistics

- Routes people/machines
- **Demolition**
- Earthworks

## •Management

- Municipal engineering

## Building area

- Waste management
- **Recycling management**
- Storage area
- Working areas
- **Dangerous materials**



Funded by the  
Erasmus+ Programme  
of the European Union

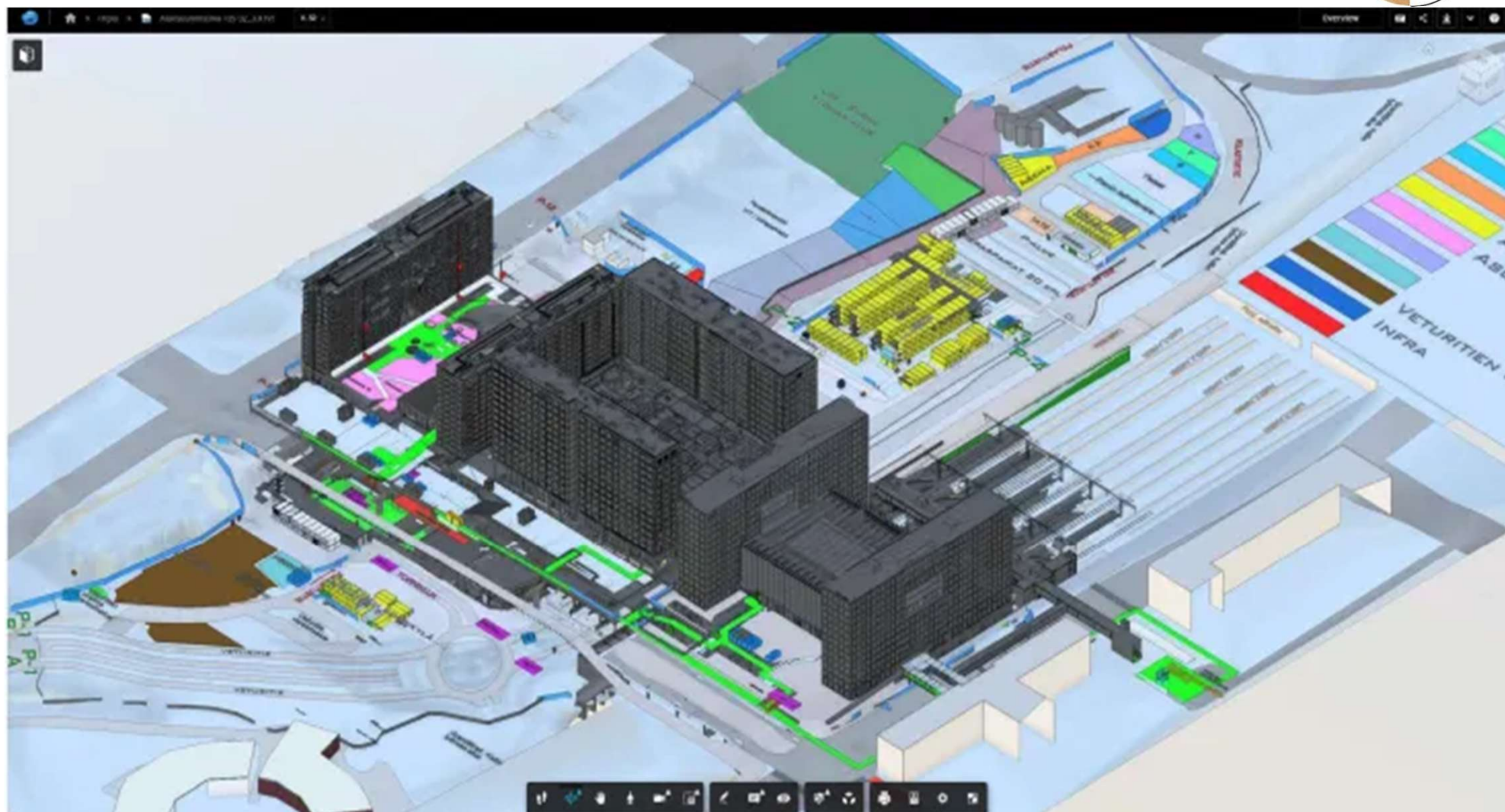





Funded by the  
Erasmus+ Programme  
of the European Union

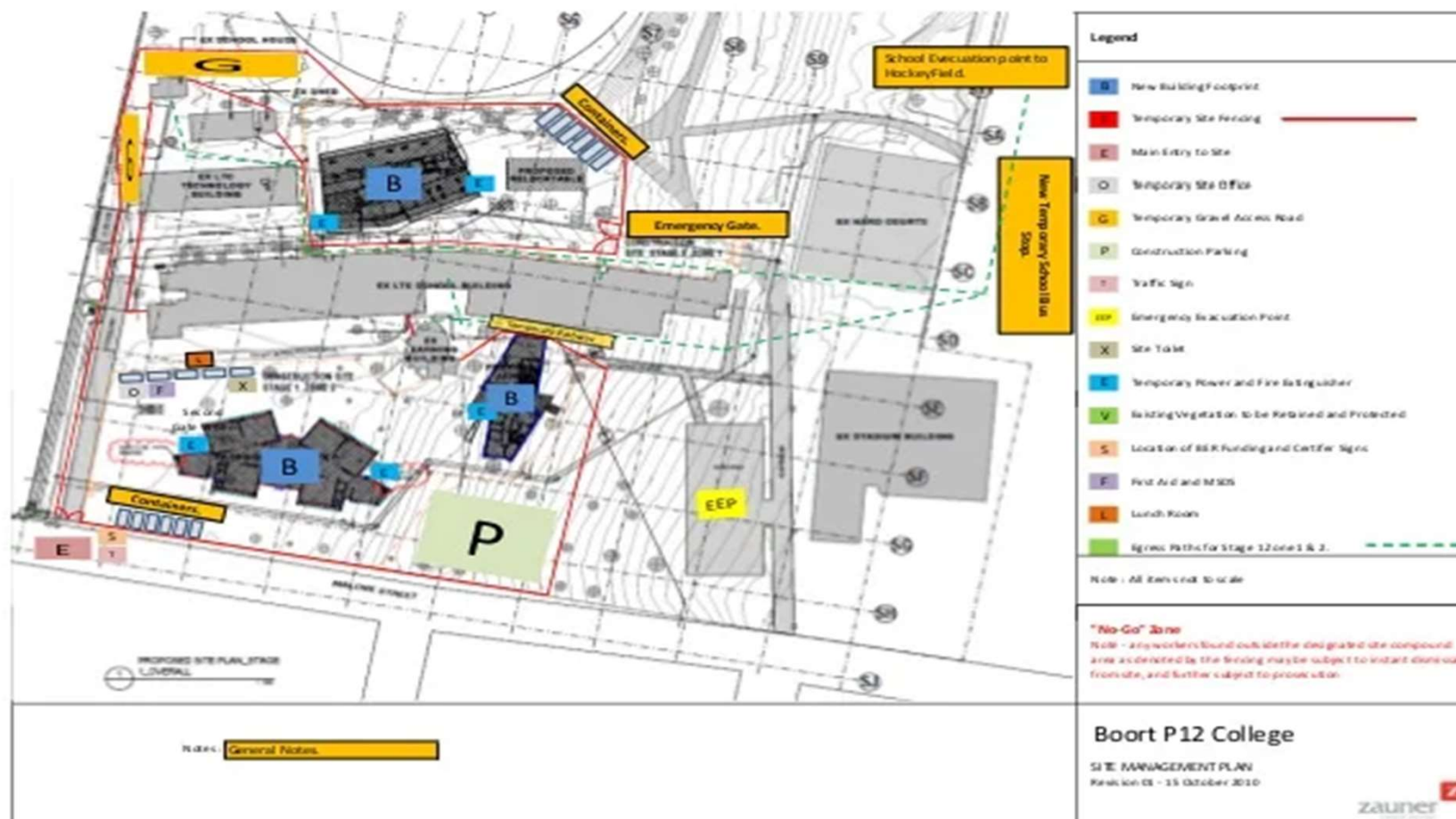
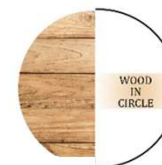



Funded by the  
Erasmus+ Programme  
of the European Union



# Safety

## Workers

- Always workers need to have safe environment to work
- Also when they have breaks they need to have place to relax

## Visitors / Client

- Safe passage to site office
- Routes so visitors won't be able to go to site by them self

## People / residents

- If there are residents or people that need to move in the site, you need to plan their safe moving/living and that their being as easy as possible

## Neighborhood

- Noise, dust, lights won't disturb residents of the area
- Sites logistics won't affect neighborhood







Funded by the  
Erasmus+ Programme  
of the European Union



# Logistics

## Routes people/machines

- People need to have safe routes that won't mix with heavy traffic (also safety)
- Machines need to have routes that are wide enough and that routes can withstand the weight of the machinery
- Machines that the site needs can operate in the area

## Demolition

- Methods that we use to break the buildings
- What we demolish and what is demolish stage
  - (100 whole building
  - 70 frame stands
  - 50 Outer lines stay (frame, and roof
  - 30 inner walls will be removed

## Earthworks

- This stage might remove roads and change the area so we need to build temporary roads and bridges





Funded by the  
Erasmus+ Programme  
of the European Union



# Management

## Municipal engineering /sites Own

- Water
  - Fresh water to drink and washing (warm water)
  - Need to build own lines so planning need to be done
  - (cold condition building, insulation)
- Electricity
  - building and demolish methods
  - power output of the site
  - machinery, crane
- Internet/communication
- Sewer system
  - Need to build own lines so planning need to be done
  - (cold condition building, insulation)





Funded by the  
Erasmus+ Programme  
of the European Union



# Building area

## Waste management

- How we could affectively handle and recycle waste materials that come from the site

## **Recycling management / circular economy**

- which structures or procuts can be recycled in other projects
- can we sell some parts

## Storage area

## Working areas

## **Dangerous materials**



Funded by the  
Erasmus+ Programme  
of the European Union

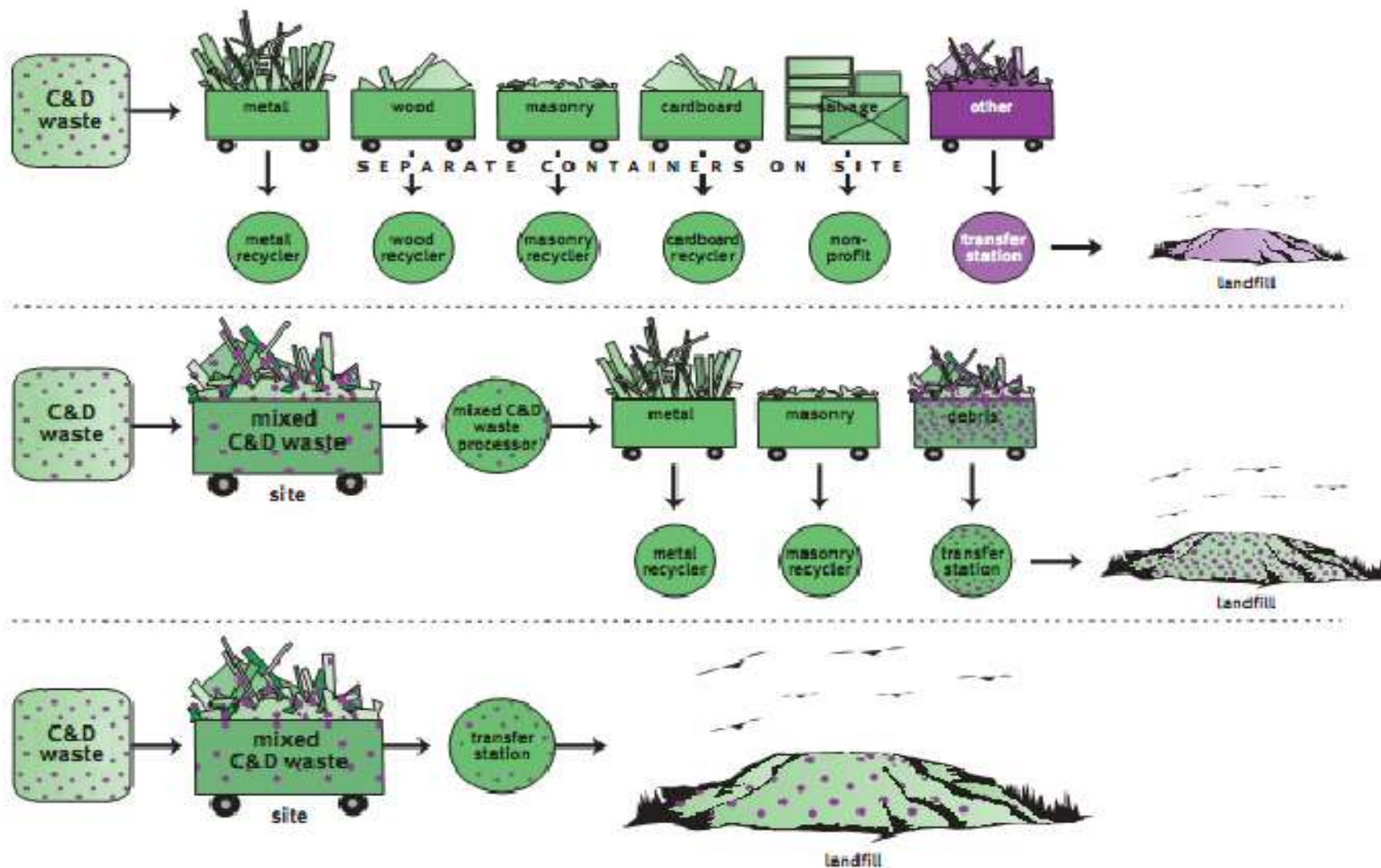
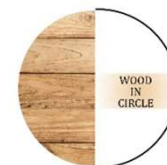



Funded by the  
Erasmus+ Programme  
of the European Union



# Speciality in Demolitionsite management

## Structural integrity research

Contaminants: bitumen, HVAC, asbestos, harmful molds

## Dust management

Use of water, method selection

## Noise management

Time limitation, method selection

## Crushing permit

Because of the noise and dust, suburb are not allowed

## Material selection

material separation

recycling area









Funded by the  
Erasmus+ Programme  
of the European Union

